



INSTALLATION GUIDE

CONTACT US

By selecting a Haiku® fan, you've chosen quality design, heightened comfort and effortless conservation. Use this guide to safely install your fan. Please contact us with any questions you may have.

United States

2348 Innovation Drive
Lexington, KY 40511
855 694 2458

Asia Pacific

18 Tampines Industrial Crescent #06-07
Singapore 528 605
+65 6709 8500

Australia/Oceania

Unit 22, 1029 Manly Road
Tingalpa QLD 4173, Australia
1 300 BIG ASS

East Asia

Room 808, Tai Yau Building
181 Johnston Road
Wan Chai, Hong Kong
+852 2836 5808

Europe

OBELIS S.A
Bd. Général Wahis, 53
1030 Brussels, Belgium
+32.2.732.59.54



← Scan for online Haiku Home app help

Installation Guide

For operation, maintenance, and troubleshooting information, visit haikuhome.com/help

Models: S3150-A2, S3150-S0, S3150-X2, S3127-A2, S3127-S0, S3127-X2, B3213-X4

<i>Topic</i>	<i>Page</i>
Technical Specifications	3
Tools Needed	3
Parts and Hardware	
Low Profile Mount	4
Standard Mount	5
Universal Mount	6
Prepare the Fan Site	7
Install Your Fan	
Airfoils	8
Lower Cover	10
Mounting Bracket	12
Mounting: Low Profile	22
Mounting: Standard	30
Mounting: Universal	42
Test Your Fan	54

READ AND SAVE THESE INSTRUCTIONS

NOTES

- ⚠️ Disconnect power to the fan location! Do not use the fan with a dimmer switch!**
- ⚠️ A licensed electrician must install the fan if required by your local electrical code.**
- ⚠️ The ground wire must be connected to the supply ground and its length must be longer than the safety cable!**

Technical Specifications

Diameter	Weight	Operating voltage	Operating frequency
132 cm	≤ 6.4 kg	100–240 VAC, 1 Φ	50–60 Hz
152 cm	≤ 7.3 kg	100–240 VAC, 1 Φ	50–60 Hz
213 cm	≤ 11.3 kg	100–240 VAC, 1 Φ	50–60 Hz

Tools Needed

- Ladder
- Wire Strippers
- Phillips Screwdriver
- Wrenches

Box Contents

As you remove the fan from its packaging, make sure you are not missing any components required for assembly and operation. If you ordered multiple fans, be sure to keep the components of each fan together!

PARTS & HARDWARE: STANDARD MOUNT

- a** Rubber bushing
- b** Mounting bracket†
- c** (2) Mounting brace bracket
- d** Wiring cover
- e** Wiring cover trim
- f** Lower cover
- g** (3) Airfoil
- h** Motor hub
- i** Remote control
- j** EMI filter (not shown)**
- k** Mounting hardware

- (2) M6 x 1 x 25 mm socket cap screw***
- (2) M6 x 1 nylock nut***
- M8 Bolt
- 8 mm flat washer
- 8 mm lock washer
- M8 nut
- 2 mm x 2 mm split pin
- Safety cable shackle****

- l** Airfoil hardware
- (6) M5 airfoil screw
- (6) 5 mm lock washer
- (6) Airfoil grommet

- m** Wiring hardware
- 3-lever wire connectors
- 5-lever wire connector****
- Wire nut
- (2) Wiring cover screw

† Do not use the mounting bracket if mounting the fan to a concrete ceiling.

** If the EMI filter is included, please install it with your fan.

*** If installing the fan to a junction box, U-shaped ceiling hook, or wood ceiling joist, only one (1) bolt and one (1) nut are needed. If installing the fan to a J-shaped ceiling hook, two (2) bolts and two (2) nuts are needed.

**** Safety cable not shown

***** Use for ground wires

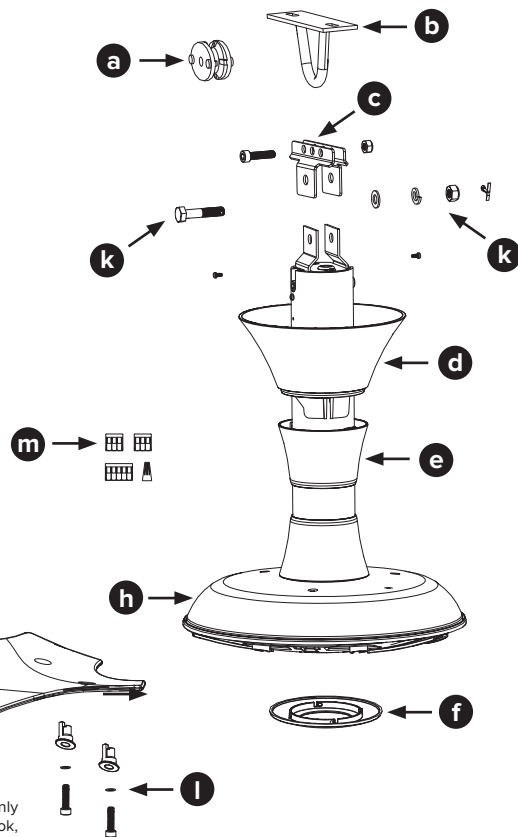
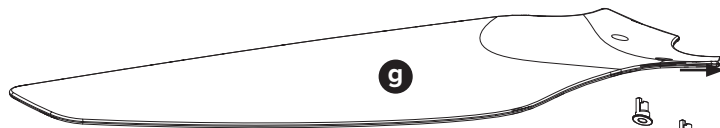
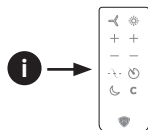

PARTS & HARDWARE: UNIVERSAL MOUNT

- a** Mounting bracket
- b** Mounting ball & wedge
- c** Canopy
- d** Extension tube
- e** Wiring cover
- f** (3) Airfoil
- g** Motor hub
- h** Lower cover
- i** Remote control
- j** EMI filter (not shown)*

k Mounting hardware

- 4 mm self-tapping screw
- 6 mm steel pin
- (6) M4 x 6 screw
- (2) M4 lock washer
- Safety cable shackle**
- (2) Motor bracket
- M6 x 32 mm bolt
- M6 x 28 mm bolt
- (2) M6 nut

l Airfoil hardware

- (6) M5 airfoil screw
- (6) 5 mm lock washer
- (6) Airfoil grommet

m Wiring hardware

- 3-lever wire connectors
- 5-lever wire connector***
- Wire nut
- Cable tie

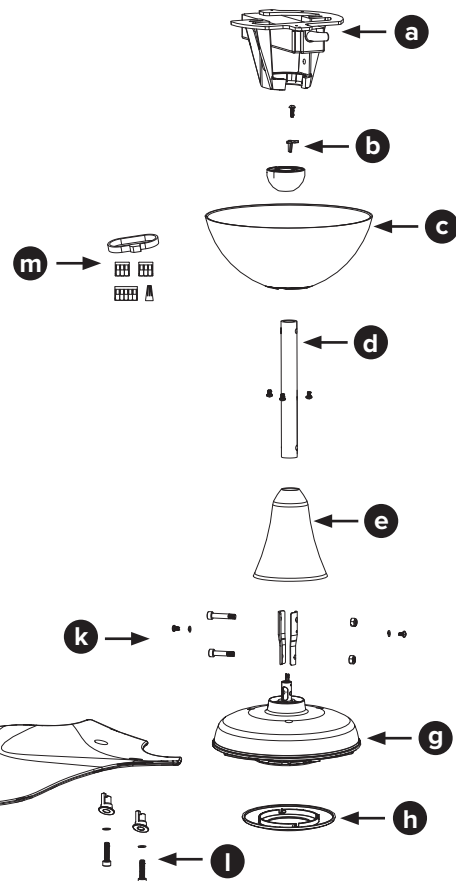
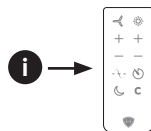
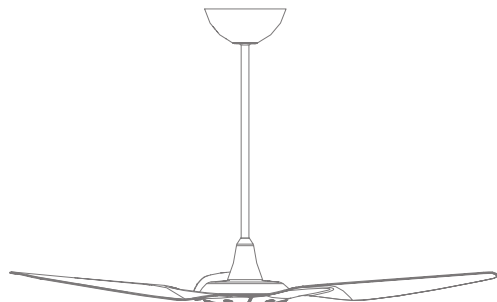

* If the EMI filter is included, please install it with your fan.

** Safety cable not shown

*** Use for ground wires

1 PREPARE THE FAN SITE



Installation requires basic electrical knowledge. Contact a licensed electrician if you are uncomfortable performing electrical work!

1 Disconnect Power!

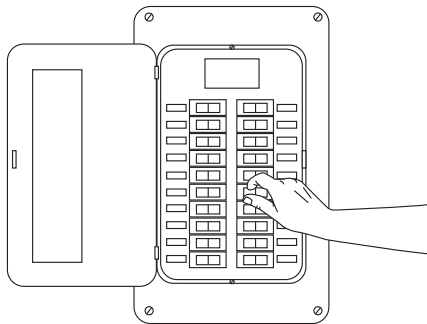

Disconnect power to the fan location before wiring the fan!



A readily accessible disconnect device shall be incorporated external to the equipment.

2 Mounting Structure

If you are installing the fan directly to the building structure or to a ceiling-mounted outlet box, the structure or outlet box must be *suitable for fan support*.

2

INSTALL THE AIRFOILS



Make sure the stickers on the airfoils match the stickers on the fan hub!

INSTALL AIRFOILS

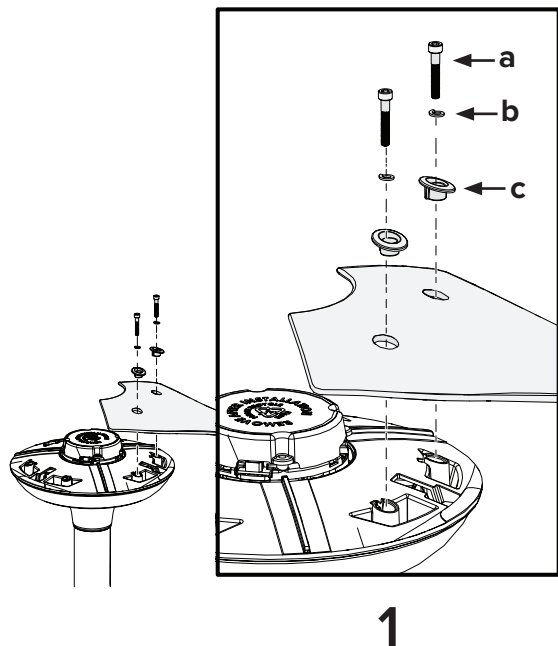

REMOVE PROTECTIVE COVER

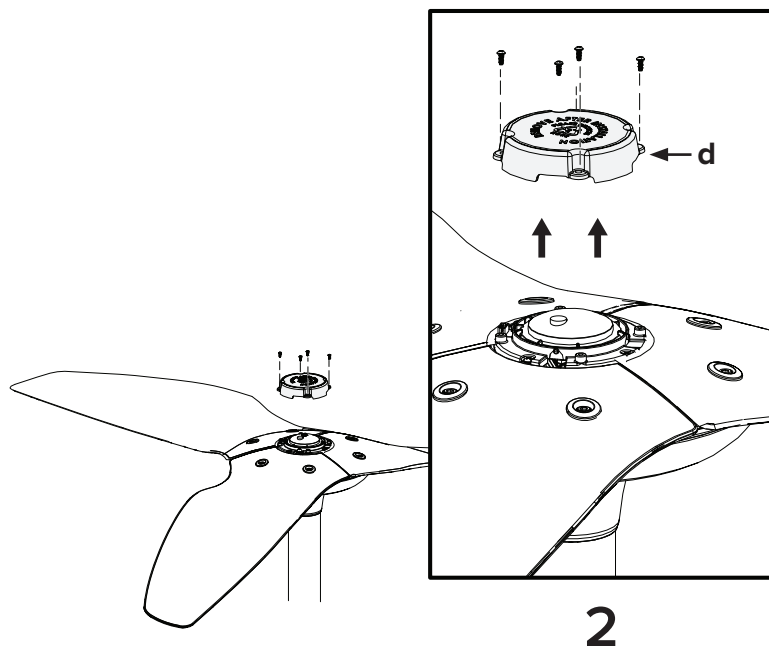

- 1 Moving clockwise around the fan, align each airfoil on the fan hub and secure it with the screws and grommets. **Make sure the stickers on the airfoils match the stickers on the fan hub.**

Hardware:

- a. M5 airfoil screw*
- b. 5 mm lock washer*
- c. Airfoil grommet*

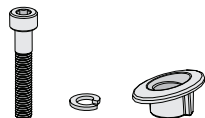

- 2 Remove and recycle the plastic protective cover (d).

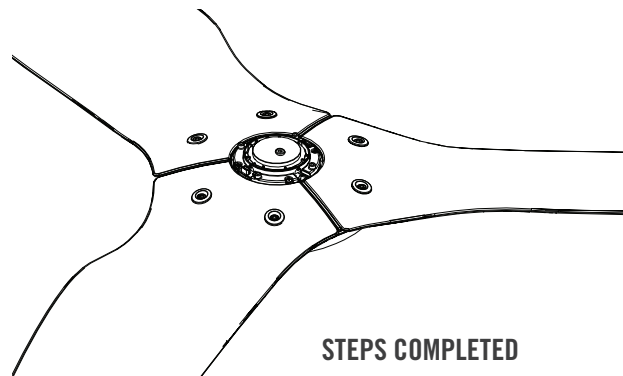

3

INSTALL THE LOWER COVER



If you purchased the Haiku Light Kit, proceed to the instructions included with the kit. Return to these instructions once the kit is installed.

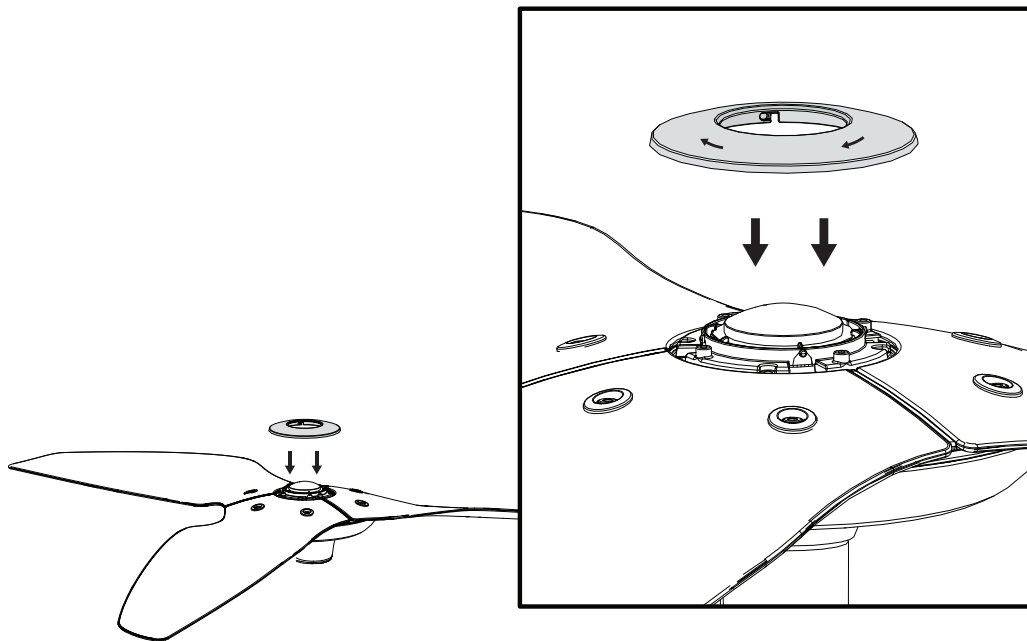

Align the four slots on the lower cover with the four small round tabs on the fan hub. Press and turn the lower cover clockwise to lock it into place.

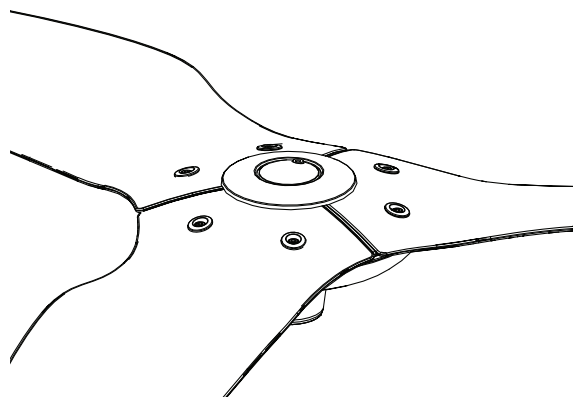

STEP COMPLETED

INSTALL THE MOUNTING BRACKET

Outlet Box

If your local electrical code requires the fan to be installed on a ceiling-mounted outlet box, the outlet box must be suitable for fan support. If there is not an outlet box at the fan location, one should be installed on a ceiling joist or beam and properly wired.

Concrete Ceiling

If installing your fan on a concrete ceiling, ensure power wiring has been routed to the fan site.

Low Profile Mount. Attach the mounting plate directly to the ceiling using four Ø 8 mm anchor bolts. If required by your local building and safety code, install a Ø 14 mm anchor hook for the safety cable.

Standard Mount. Install the fan where there is a ceiling hook or other sufficient structural support. If there is not a hook at the fan site, install a hanger plate using three Ø 12–12.5 mm anchor bolts. *Do not use the mounting bracket supplied with the fan.* If required by your local building and safety code, install an Ø 8–8.5 mm anchor hook for the safety cable.

Universal Mount. Attach the mounting bracket directly to the ceiling using three Ø 6 mm anchor bolts. If required by your local building and safety code, install an Ø 8 mm anchor hook for the safety cable.

Wood Ceiling Joist

If installing your fan on a wood ceiling joist, ensure power wiring has been routed to the fan site. Attach the mounting plate or mounting bracket directly to the joist using two wood screws (not supplied). Haiku Home recommends using corrosion-resistant 12-11 x 45 mm hex head timber screws with seal.

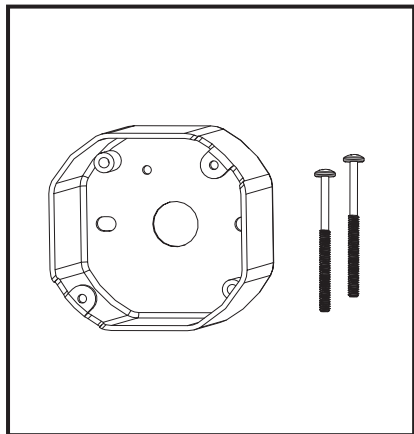

4a

Outlet Box
Page 14

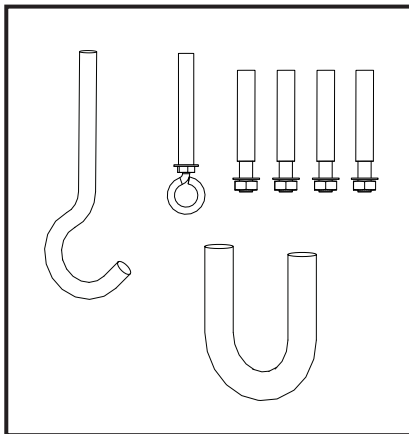

4b

Concrete Ceiling
Page 16

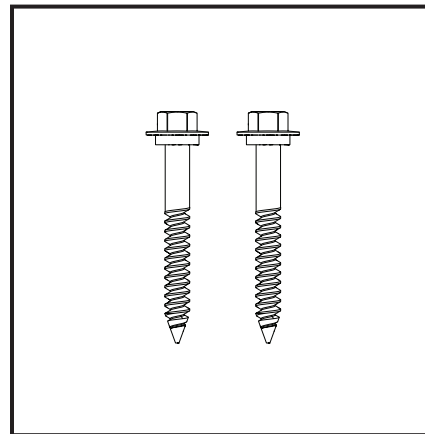

4c

Wood Ceiling Joist
Page 18

4a INSTALL THE MOUNTING BRACKET (OUTLET BOX)

Low Profile Mount

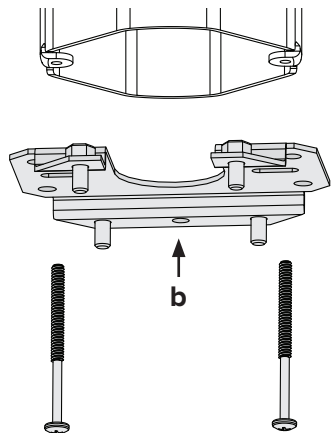

Installation may vary. Refer to the outlet box instructions.

Standard Mount

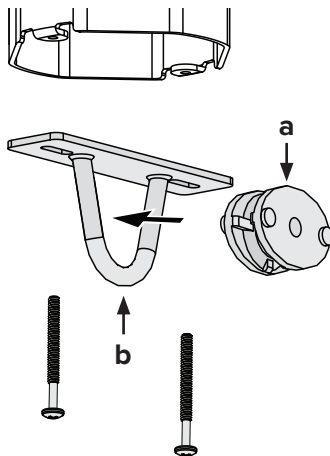

Installation may vary. Refer to the outlet box instructions.

Universal Mount

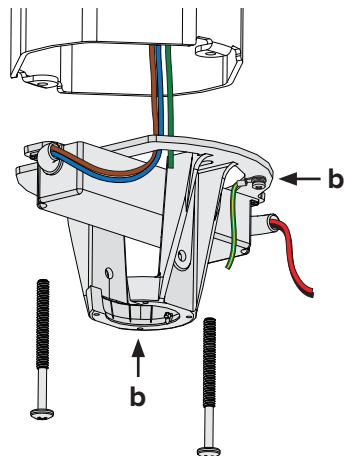

Installation may vary. Refer to the outlet box instructions.

⚠ Make sure power is disconnected from the fan location before installing the mounting plate or mounting bracket!

If installing a Standard Mount fan, seat the rubber bushing (a) in the eye of the mounting bracket.

Secure the mounting plate or mounting bracket (b) to the outlet box with the **hardware supplied with the outlet box**. Refer to the outlet box instructions.

If installing a Universal Mount fan to a sloped ceiling, secure the mounting bracket so that the open side of the bracket is facing up the slope of the ceiling.

4b INSTALL THE MOUNTING BRACKET (CONCRETE CEILING)



Install an anchor hook for the safety cable if required by your local building and safety code.

Low Profile Mount

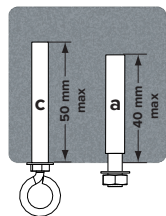
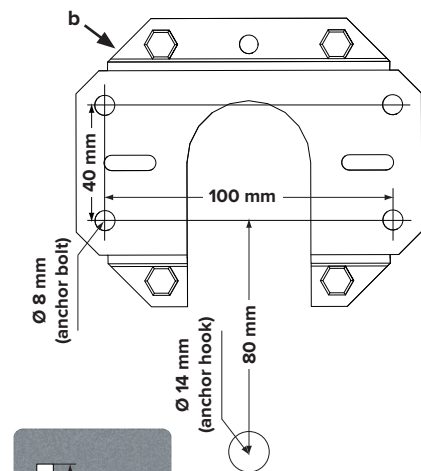

Standard Mount

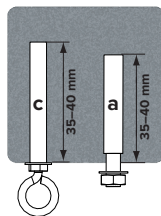
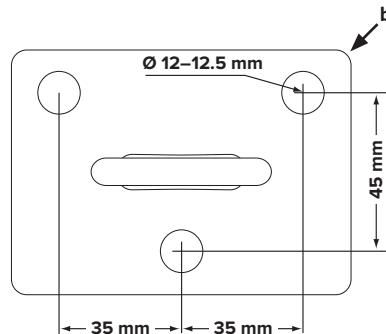

Universal Mount

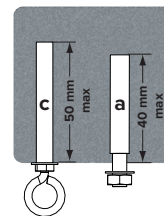
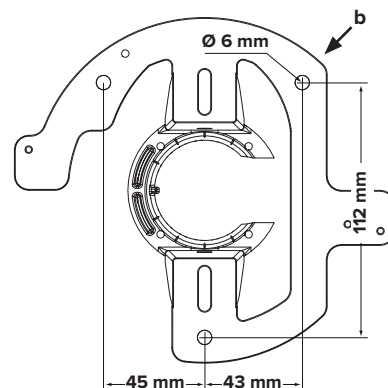

⚠ Make sure power is disconnected from the fan location before installing the mounting plate or mounting bracket!

Low Profile Mount

Drill four Ø 8 mm holes in the pattern shown. The hole depth should not exceed 40 mm.

Remove any dust from the holes. Insert four anchor bolts (a) into the holes. Strike the heads of the anchor bolts with a hammer, ensuring the bolt sleeves are flush with the ceiling surface.

Position the mounting plate (b) on the anchor bolts. Ensure all four anchor bolts are fully tightened to expand and lock the anchors.

If required by local building and safety codes, install an anchor hook (c) for the safety cable. Drill a Ø 14 mm hole for the anchor hook in the pattern shown. The hole depth should not exceed 50 mm. Remove any dust from the hole, and then insert the anchor hook and fully tighten.

Standard Mount

Drill three Ø 12–12.5 mm holes in the pattern shown. The hole depth should not exceed 35–40 mm.

Remove any dust from the holes. Insert three anchor bolts (a) into the holes. Strike the heads of the anchor bolts with a hammer, ensuring the bolt sleeves are flush with the ceiling surface.

Position the hanger plate (b) on the anchor bolts. Ensure all three anchor bolts are fully tightened to expand and lock the anchors.

If required by local building and safety codes, install an anchor hook (c) for the safety cable. Drill an Ø 8–8.5 mm hole for the anchor hook adjacent to the hanger plate. The hole depth should not exceed 35–40 mm. Remove any dust from the hole, and then insert the anchor hook and fully tighten.

Universal Mount

Drill three Ø 6 mm holes in the pattern shown. The hole depth should not exceed 40 mm.

Remove any dust from the holes. Insert three anchor bolts (a) into the holes. Strike the heads of the anchor bolts with a hammer, ensuring the bolt sleeves are flush with the ceiling surface.

Position the mounting bracket (b) on the anchor bolts. Ensure all three anchor bolts are fully tightened to expand and lock the anchors.

If required by local building and safety codes, install an anchor hook (c) for the safety cable. Drill an Ø 8 mm hole for the anchor hook. The hole depth should not exceed 50 mm. Remove any dust from the hole, and then insert the anchor hook and fully tighten.

4c INSTALL THE MOUNTING BRACKET (WOOD CEILING JOIST)

Low Profile Mount

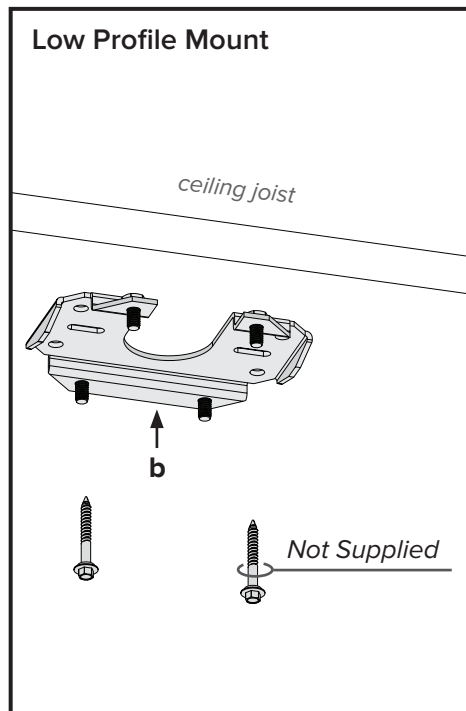

Standard Mount

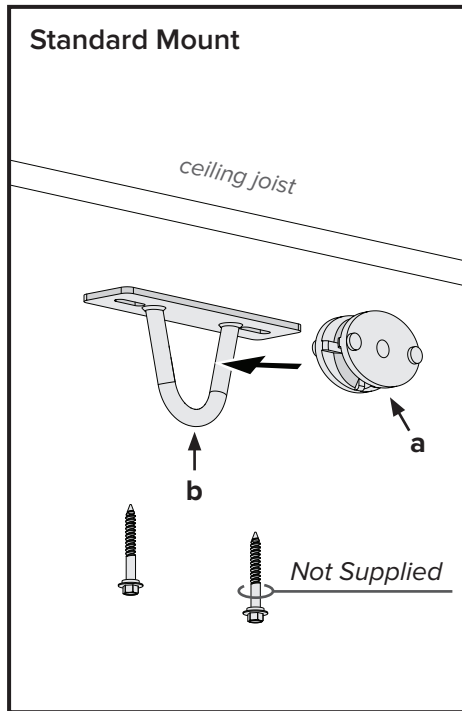

Universal Mount

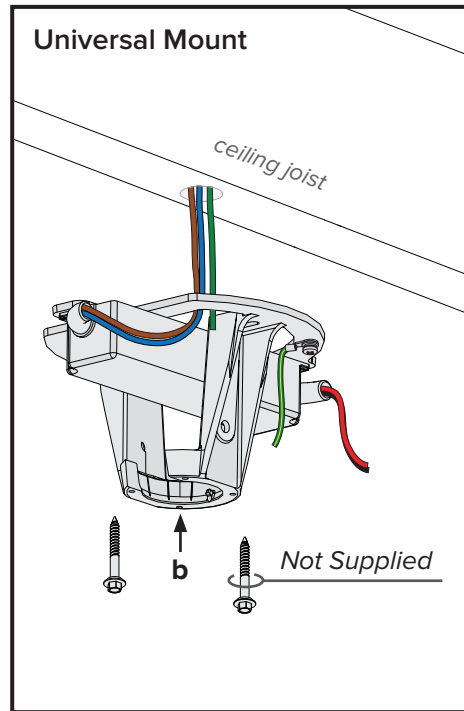

⚠ Make sure power is disconnected from the fan location before installing the mounting plate or mounting bracket!

If installing a Standard Mount fan, seat the rubber bushing (a) in the eye of the mounting bracket.

Secure the mounting plate or mounting bracket (b) to the joist with two 12-11 x 45 mm hex head timber screws with seal (not supplied).

If installing a Universal Mount fan to a sloped ceiling joist, secure the mounting bracket so that the open side of the bracket is facing up the slope of the joist.

MOUNT THE FAN

Low Profile Mount

The low profile mount can be installed on flat ceilings that are as low as 8 feet (2.4 m). This mount is available for fans with 52-inch (132-cm) or 60-inch (152-cm) diameters.

Standard Mount

The standard mount moves air most efficiently when installed on flat ceilings ranging from 8.5–12 feet (2.5–3.7 meters) tall. This mount is available for fans with 52-inch (132-cm) or 60-inch (152-cm) diameters.

Universal Mount

The universal mount can be installed on sloped or flat ceilings ranging from 8.5–18 feet (2.5–5.5 meters) tall. This mount is available for fans with 52-inch (132-cm), 60-inch (152-cm), or 84-inch (213-cm) diameters.

5a

Low Profile Mount
Page 22



5b

Standard Mount

Page 30

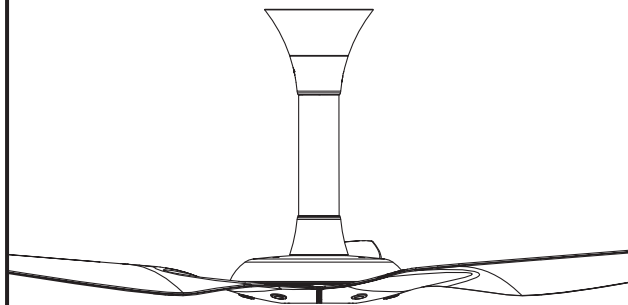

5c

Universal Mount

Page 42

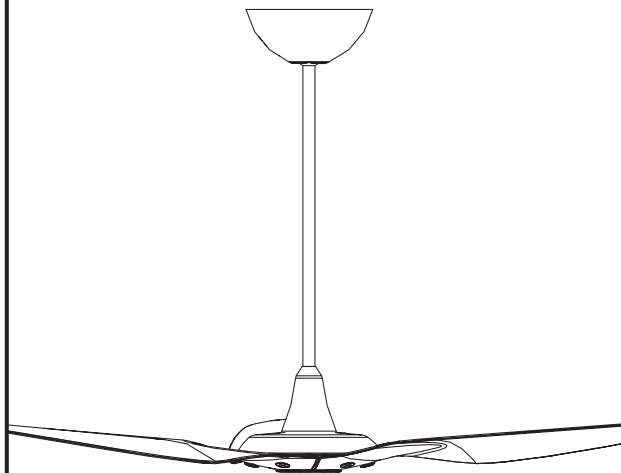

5a MOUNTING: LOW PROFILE

INSTALL RUBBER BUMPERS

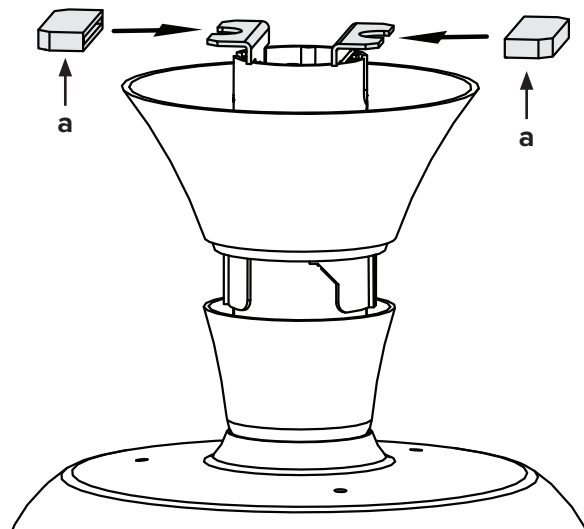

1

- 1 Slide the rubber bumpers (a) onto the extension tube brackets.

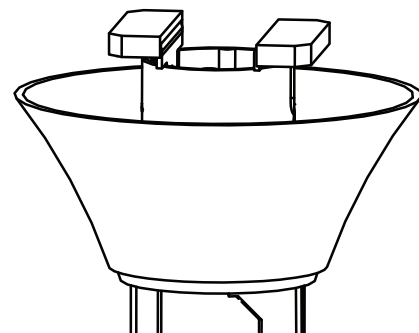

STEP COMPLETED

SUPPORT FAN

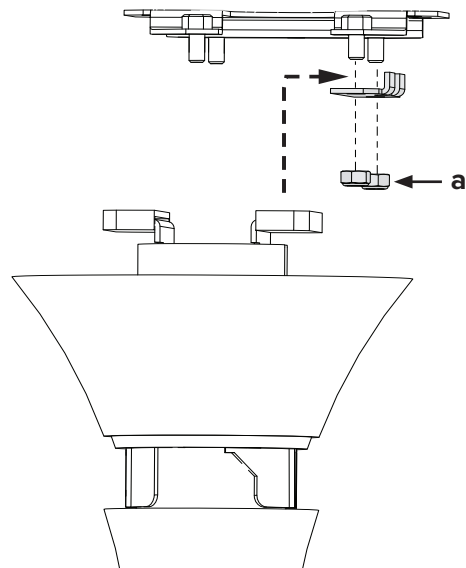

2

SECURE SAFETY CABLE

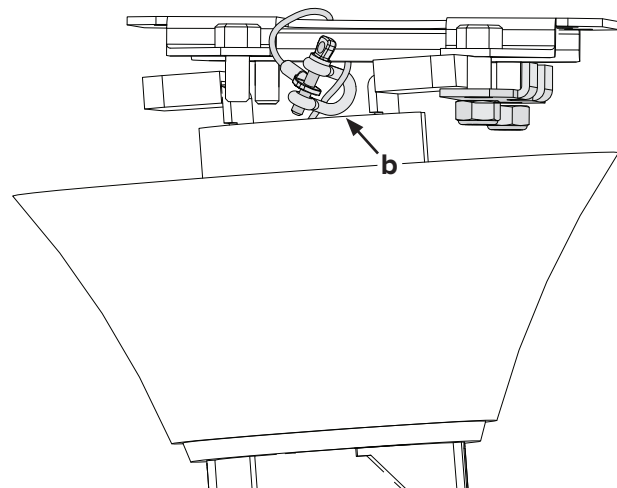

3

- 2** Loosely attach one mounting bracket to the mounting plate with the nylock nuts, but do not fully tighten. Raise the fan to the bracket and temporarily rest one rubber bumper in the space between the bracket and plate. This provides extra support when securing the safety cable.

Hardware:

a. 6 mm nylock nuts



- 3** While supporting the fan, loop the safety cable around the mounting plate or building structure, and then secure it with the shackle (b). Allow the fan to hang from the safety cable.

Hardware:

b. Shackle

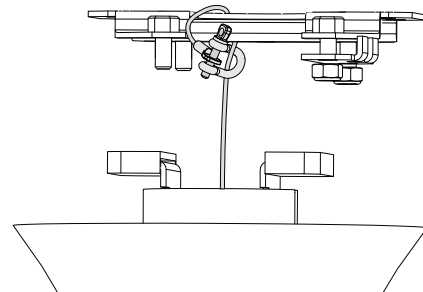
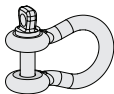

STEPS COMPLETED

Wiring Diagram

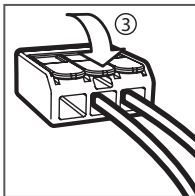
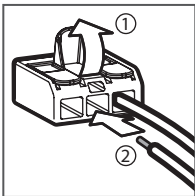
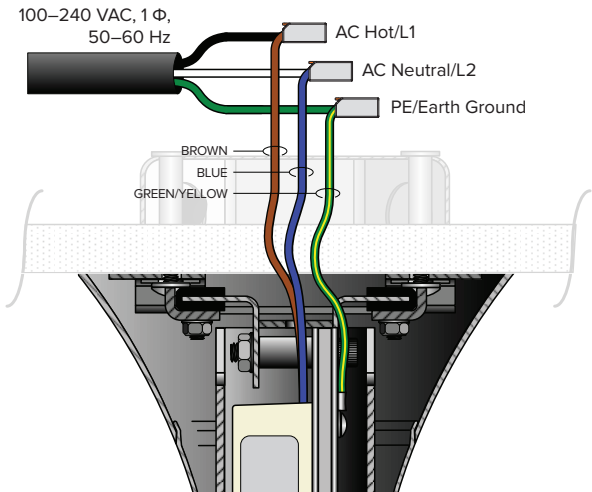

Wiring Diagram (with EMI Filter)

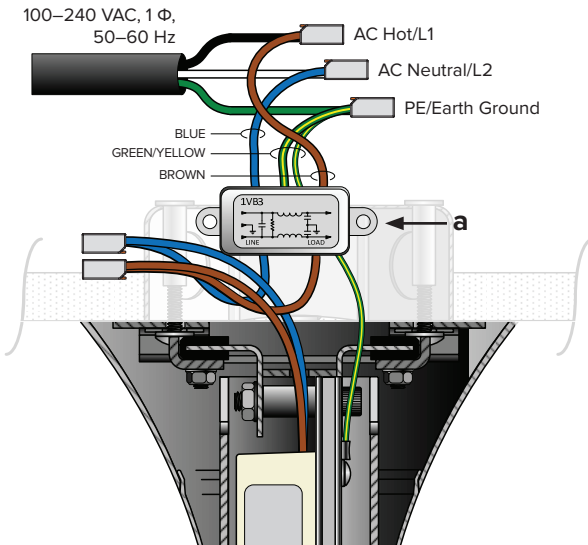

- ⚠️ Disconnect power to the fan location before wiring the fan!**
 - ⚠️ A licensed electrician must install the fan if required by your local electrical code.**
 - ⚠️ Do not connect the fan to a damaged power source! Do not attempt to resolve electrical failures on your own. Consult a qualified electrician if uncertain of the electrical installation of this fan.**
- 4** With the fan hanging from the safety cable, insert the fan wires and ceiling wires into the wire connectors. If the EMI filter (α) is included, install it with your fan. Test the connection by lightly tugging on the wires.

	AC Hot/L1 Brown	AC Neutral/L2 Blue	PE/Earth Ground (connected to fan chassis) Green with Yellow Tracer
Australia	Brown or Red	Black or Light Blue	Green with Yellow Tracer
All other regions	Brown	Blue	

INSTALL MOUNTING BRACKETS

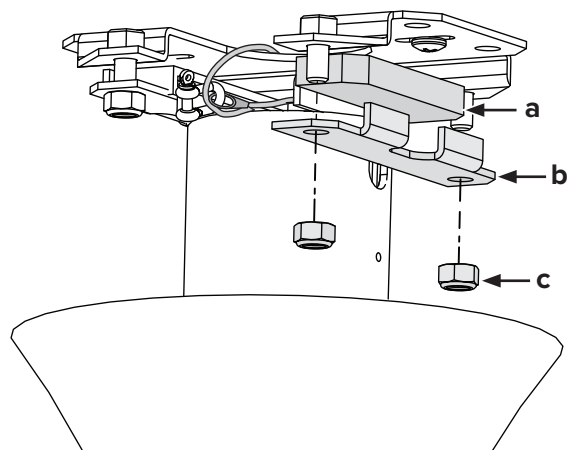

5

INSTALL WIRING COVER AND TRIM

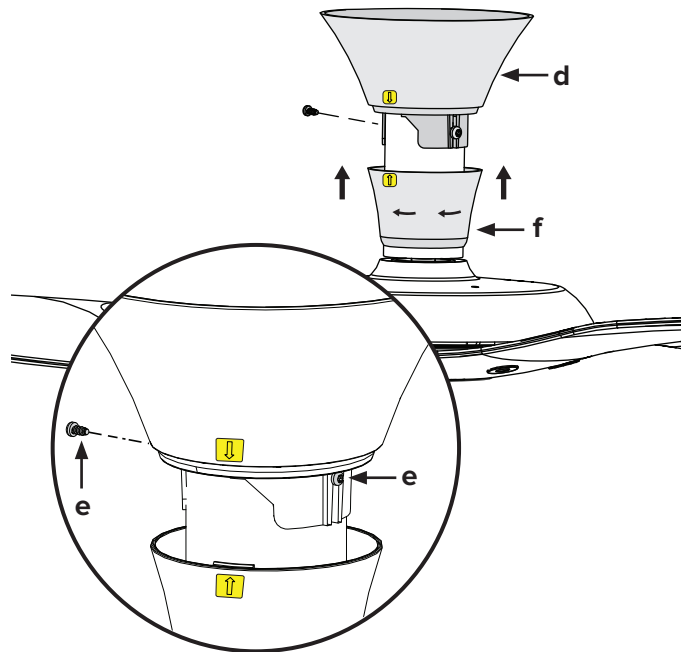

6

- 5** Raise the fan to the mount. Insert one rubber bumper between the mounting plate and the loosely installed mounting bracket. Position the other rubber bumper (a), and then secure it with the remaining mounting bracket (b) and the nuts. Tighten all hardware.

Hardware:

c. 6 mm nylock nuts



- 6** Slide the wiring cover (d) up the extension tube, allowing about a 1/8" (3 mm) gap to the ceiling. Rotate the cover so that the mounting slots align with the screw holes on the extension tube, and then secure it with the screws (e).

Slide the trim (f) up the extension tube, aligning the tabs on the inside with the slots on the bottom of the wiring cover. Twist clockwise to snap the trim into position.

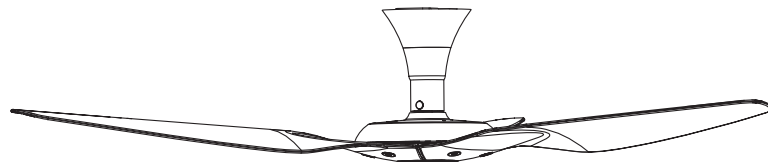

INSTALLATION COMPLETED

5b

MOUNTING: STANDARD

POSITION WIRING COVER AND TRIM

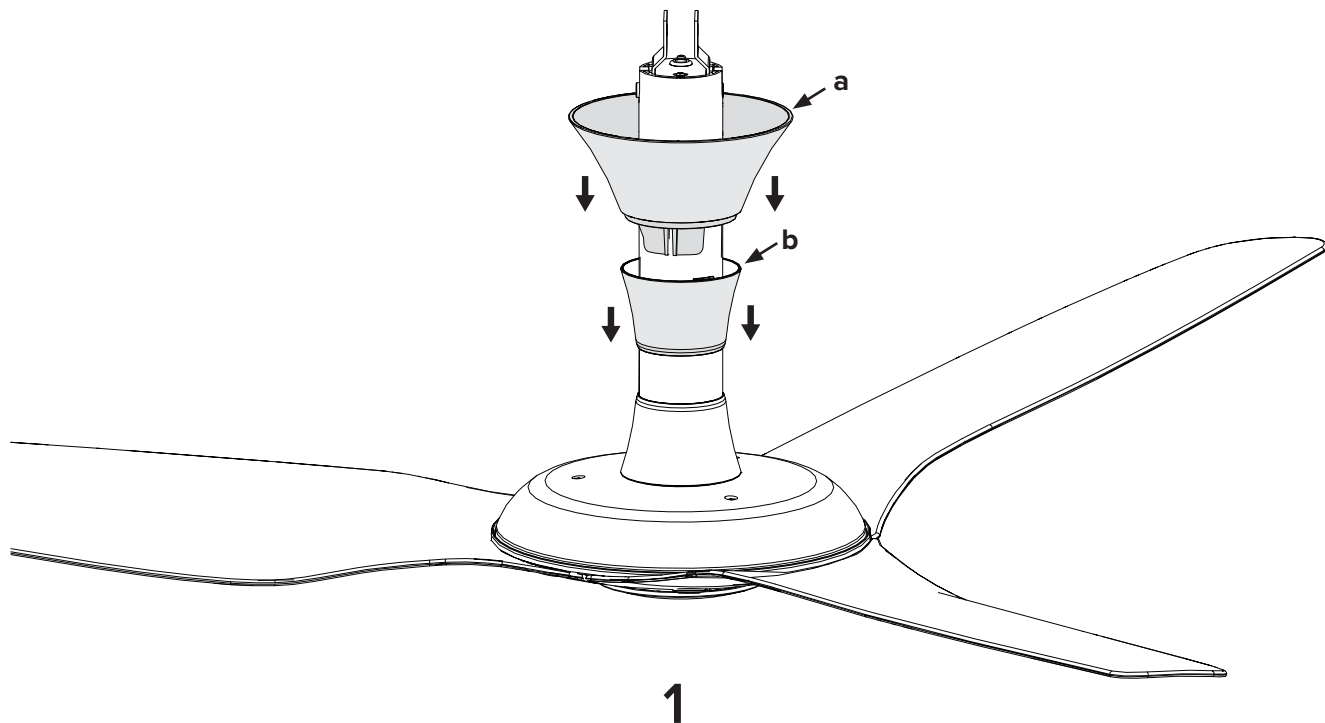

- 1 With the fan in the upright position, remove the protective covering from the extension tube. Slide the wiring cover (a) and wiring cover trim (b) over the extension tube, resting them on the fan hub.

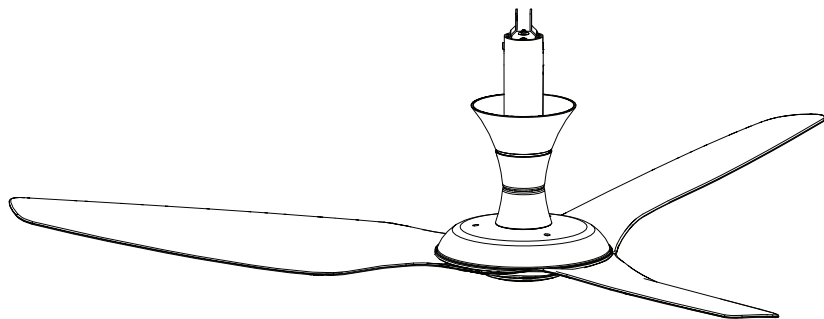

STEP COMPLETED

SECURE MOUNT BRACE BRACKETS

Outlet Box or Wood Joist

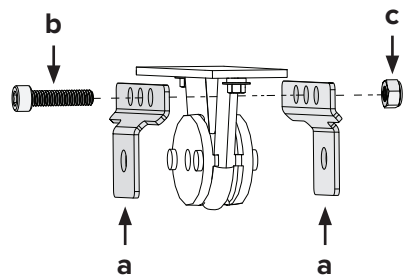

J-Shaped Ceiling Hook

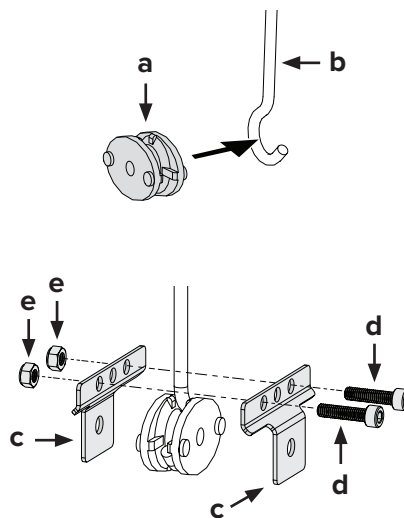

U-Shaped Ceiling Hook

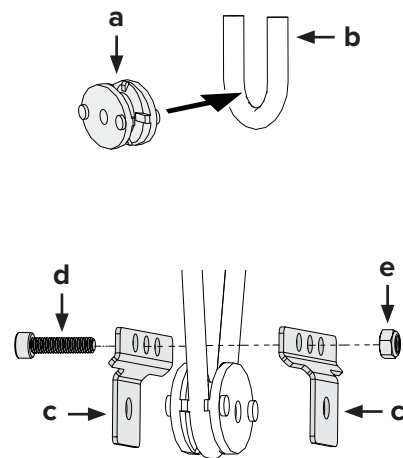

2 Outlet Box or Wood Ceiling Joist

Loosely install the mount brace brackets (a) with the provided hardware. One bolt should be inserted in the middle hole. Do not fully tighten the hardware.

Hardware:

b. M6 x 1 x 25 mm socket cap screw

c. M6 x 1 nylock nut

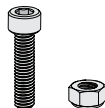

J-Shaped Ceiling Hook

Make sure the ceiling hook is cast into the concrete ceiling. Seat the rubber bushing (a) in the eye of the ceiling hook (b). Loosely install the mount brace brackets (c) with the provided hardware. Two bolts should be inserted in the outer holes. Do not fully tighten the hardware.

Hardware:

d. M6 x 1 x 25 mm socket cap screws

e. M6 x 1 nylock nuts

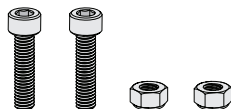

U-Shaped Ceiling Hook

Make sure the ceiling hook is cast into the concrete ceiling. Seat the rubber bushing (a) in the eye of the ceiling hook (b). Loosely install the mount brace brackets (c) with the provided hardware. One bolt should be inserted in the middle hole. Do not fully tighten the hardware.

Hardware:

d. M6 x 1 x 25 mm socket cap screw

e. M6 x 1 nylock nut

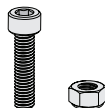

HANG FAN

Outlet Box or Wood Joist

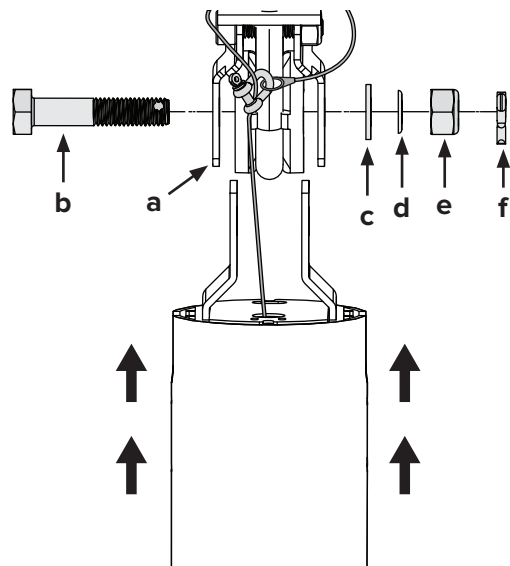

Concrete Ceiling

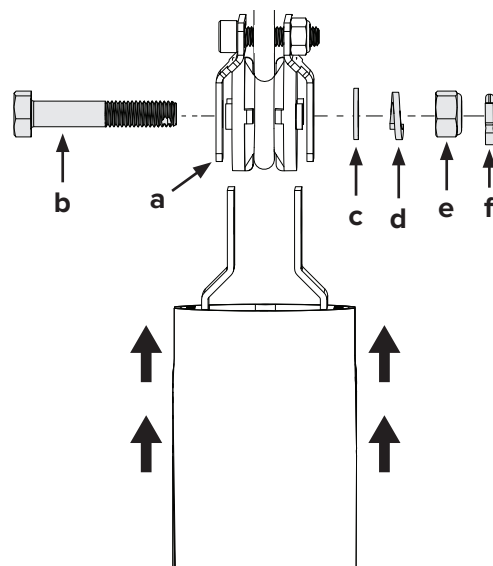

- 3** Raise the extension tube to the mount, and insert the extension tube brackets between the mount brackets (a) and the rubber bushing so that the mounting holes are aligned. Secure the extension tube with the mounting hardware. *Fully tighten all hardware so that the brackets are slightly bent.*

Hardware:

b. M8 bolt

c. 8 mm flat washer

d. 8 mm lock washer

e. M8 nut

f. 2 mm x 2 mm split pin

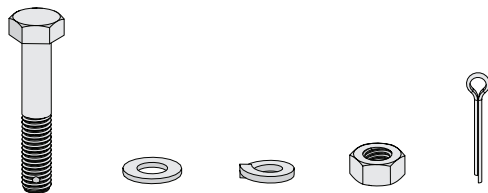

SECURE SAFETY CABLE

Outlet Box or Wood Joist

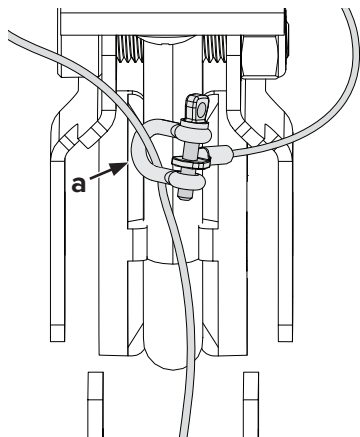
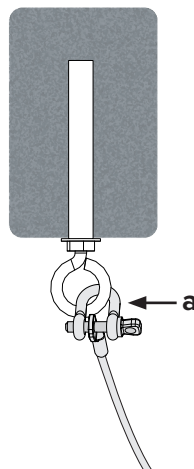
J-Shaped Ceiling Hook or
Hanger Plate

U-Shaped Ceiling Hook

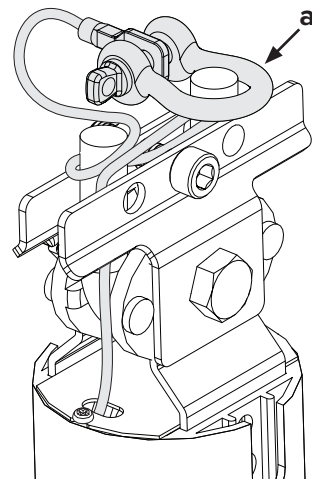

4

4 Outlet Box or Wood Ceiling Joist

Loop the safety cable around the mounting bracket or building structure, and then secure it with the shackle (a).

J-Shaped Ceiling Hook or Hanger Plate

Secure the safety cable to an anchor hook that is properly installed in the concrete ceiling. Loop the safety cable around the ceiling hook and through the anchor hook, and then secure it with the shackle (a).

U-Shaped Ceiling Hook

Loop the safety cable around the ceiling hook, and then secure it with the shackle (a).

Hardware:

a. Shackle

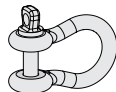

Wiring Diagram

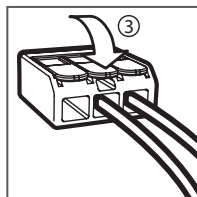
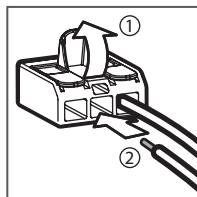
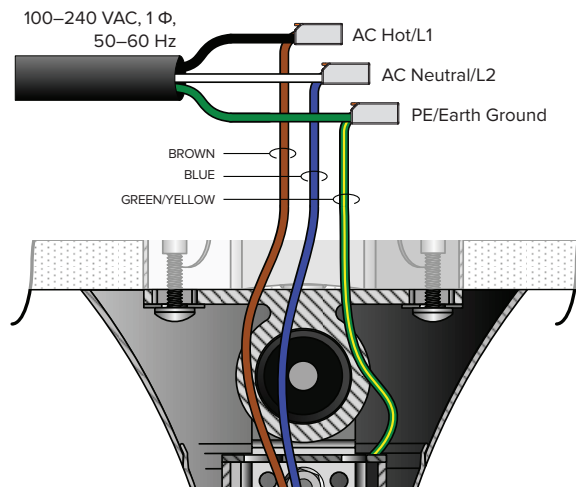
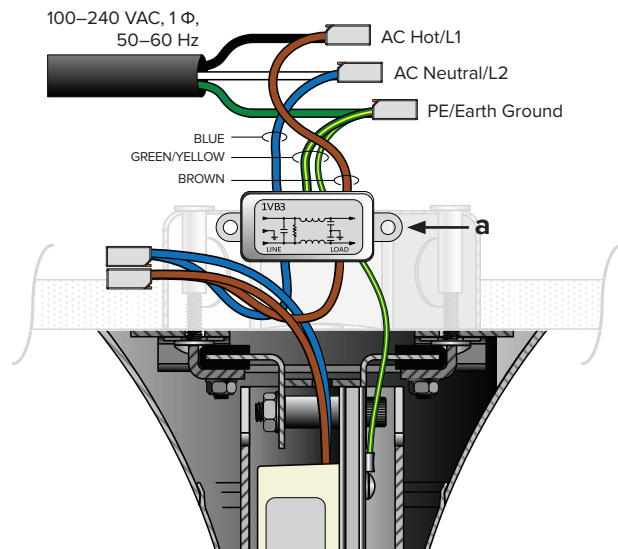
Wiring Diagram
(with EMI Filter)

- ⚠️ Disconnect power to the fan location before wiring the fan!**
 - ⚠️ A licensed electrician must install the fan if required by your local electrical code.**
 - ⚠️ Do not connect the fan to a damaged power source! Do not attempt to resolve electrical failures on your own. Consult a qualified electrician if uncertain of the electrical installation of this fan.**
- 5** Insert the fan wires and ceiling wires into the wire connectors.
If the EMI filter (α) is included, install it with your fan. Test the connection by lightly tugging on the wires.

	AC Hot/L1 Brown	AC Neutral/L2 Blue	PE/Earth Ground (connected to fan chassis) Green with Yellow Tracer
Australia	Brown or Red	Black or Light Blue	Green with Yellow Tracer
All other regions	Brown	Blue	

INSTALL WIRING COVER

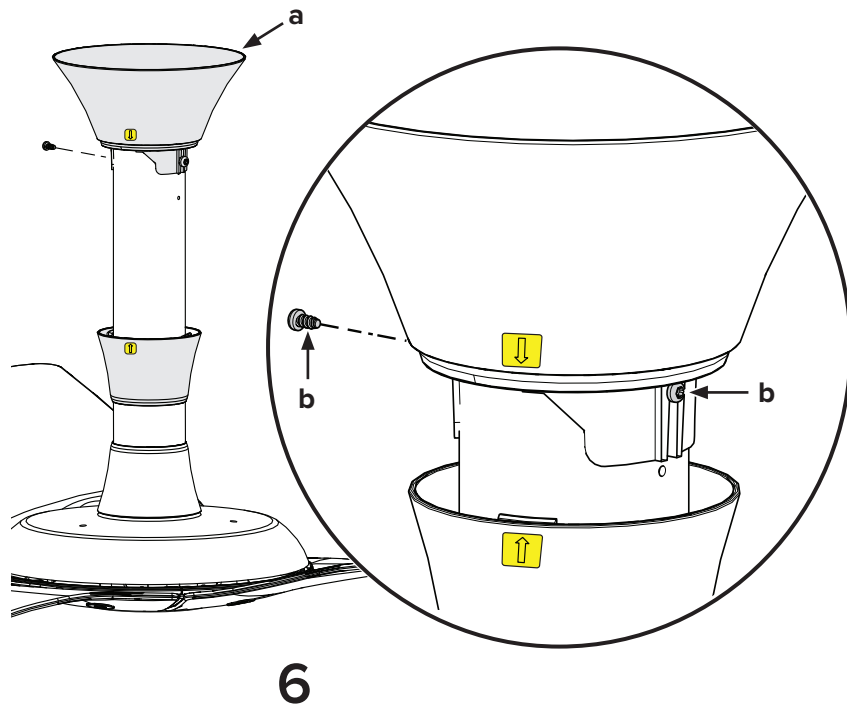

INSTALL WIRING COVER TRIM

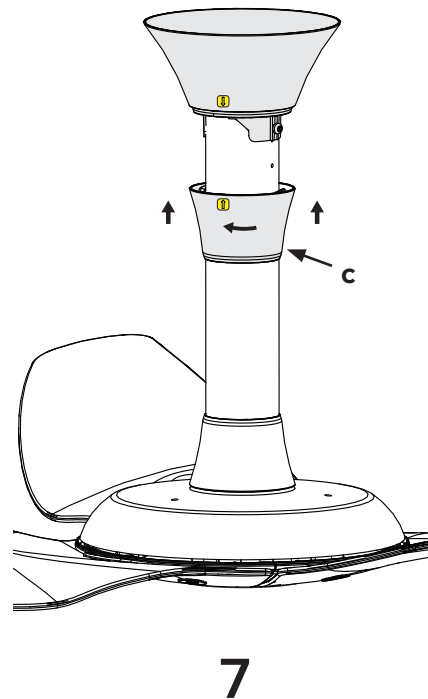

- 6** Slide the wiring cover (a) up the extension tube, allowing about a 1/8" (3 mm) gap to the ceiling. Rotate the wiring cover so that the mounting slots align with the screw holes on the extension tube, and then secure it with the screws (b). Make sure that there are no wires visible. *If there is not enough clearance between the cover and ceiling, move the screw to the lower hole.*
- 7** Slide the wiring cover trim (c) up the extension tube, aligning the tabs on the inside with the slots on the bottom of the wiring cover. Twist clockwise to snap into position.

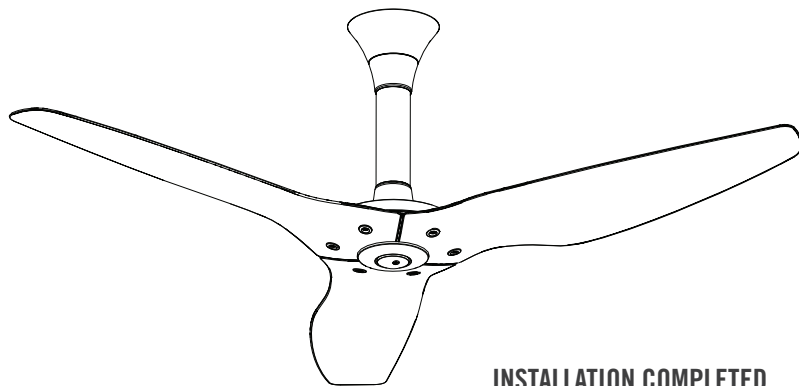

5c MOUNTING: UNIVERSAL

Make sure the extension tube is oriented so that the wiring connector properly mates with the connector from the fan hub.

INSTALL MOTOR BRACKETS

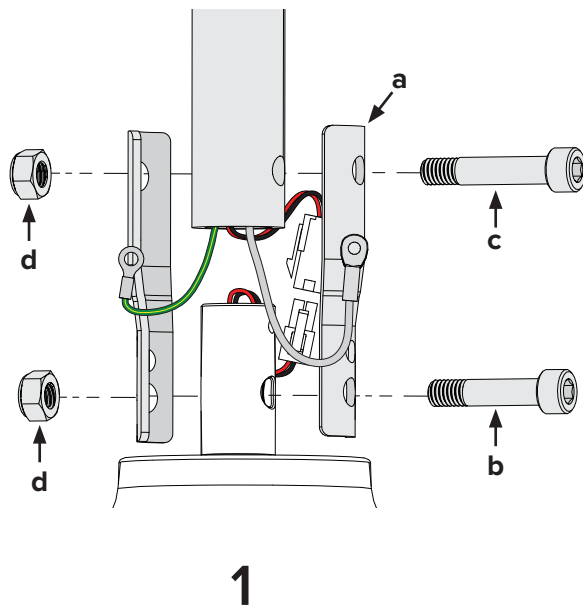

CONNECT WIRING HARNESS

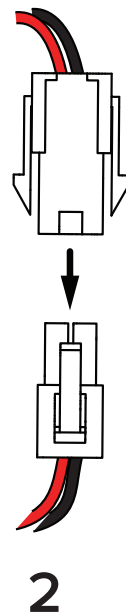

- 1** With the fan in the upright position, loosely secure the motor brackets (a) to the motor shaft with the M6 x 28 mm bolt (b) and nut (d). Install the extension tube with the M6 x 32 mm bolt (c) and nut (d). Securely tighten both bolts.

Hardware:

b. M6 x 28 mm bolt

c. M6 x 32 mm bolt

d. M6 nut

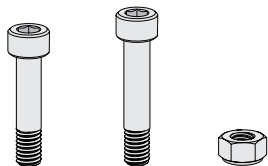

- 2** Plug the wiring harness from the extension tube into the wiring harness from the fan.

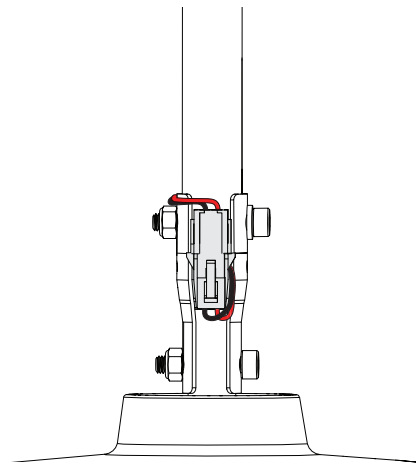

STEPS COMPLETED

INSTALL LOWER SAFETY CABLE & GROUND

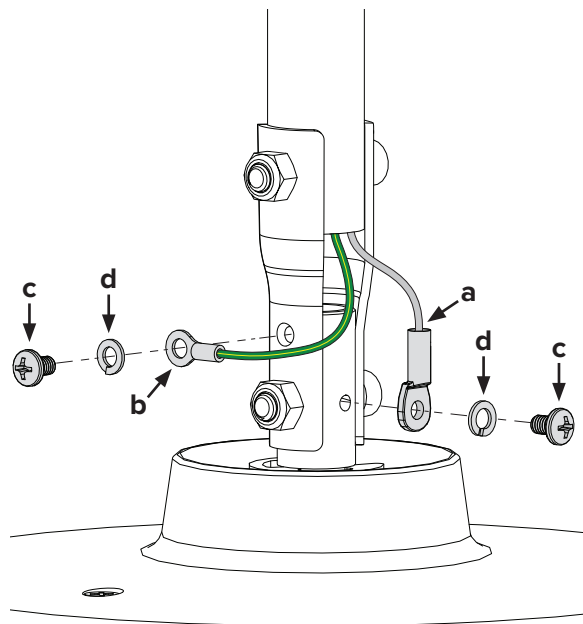

3

SECURE WIRING HARNESS

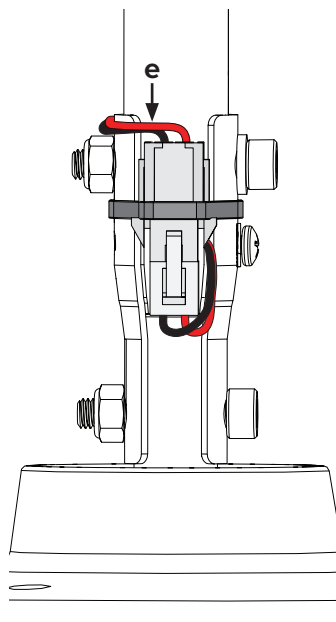

4

PREPARE WIRING COVER

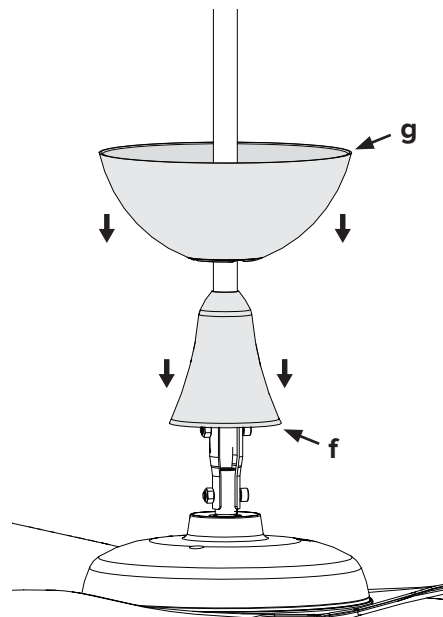

5



Make sure the wires are tightly secured against the motor brackets so that the wiring cover seats properly.

- 3** Install the safety cable (a) and ground wire (b) lugs with the unpainted screws (c) and lock washers (d).

Hardware:

c. Unpainted M4 x 6 mm screws

d. M4 lock washers



- 4** Secure the wiring harness (e) to the motor brackets with the provided cable tie. Make sure the wires are tightly secured against the motor brackets so that the wiring cover seats properly.

- 5** Slide the wiring cover (f) down the extension tube, resting it on the fan hub. Make sure no wires are visible between the cover and fan hub. Slide the canopy (g) down the extension tube.

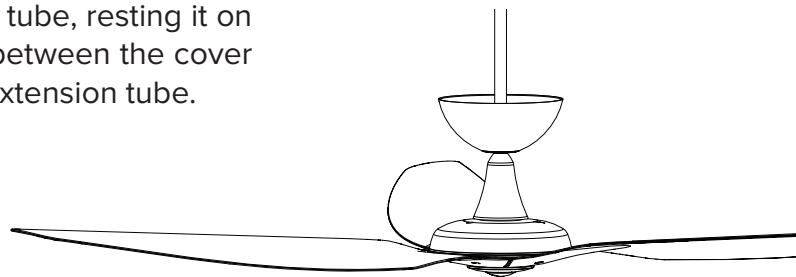

STEPS COMPLETED

POSITION MOUNTING BALL

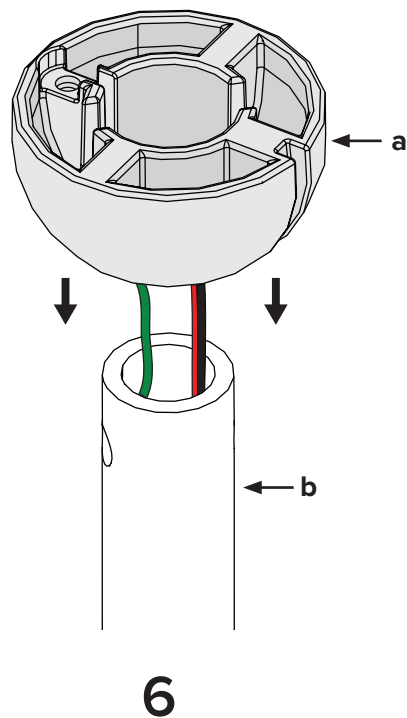

INSTALL STEEL PIN

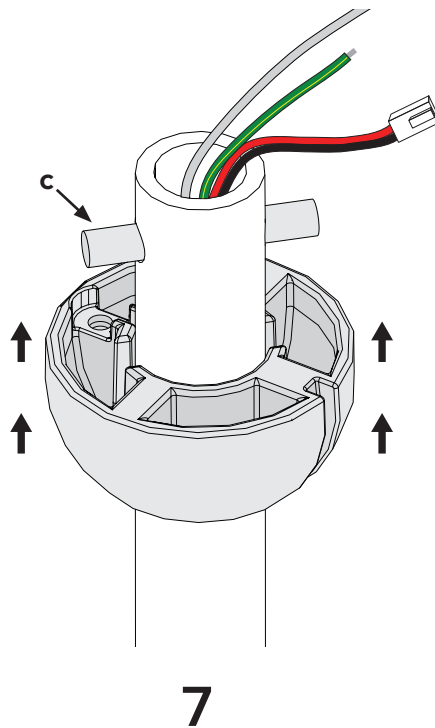

INSTALL WEDGE

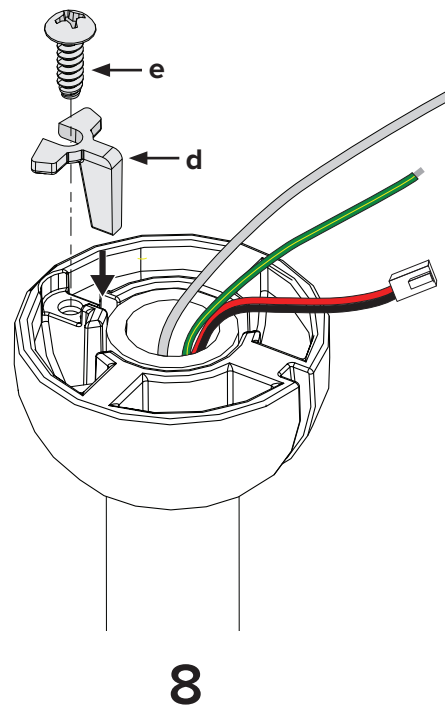

- 6 Slide the mounting ball (a) over the extension tube (b).
- 7 Insert the 6 mm steel pin (c) into the hole at the top of the extension tube, and then slide the mounting ball upward, seating the steel pin in the inner slots.
- 8 Insert the wedge (d) into the mounting ball and secure it with the screw (e). Tighten the screw enough to prevent movement between the mounting ball and extension tube, but do not overtighten.

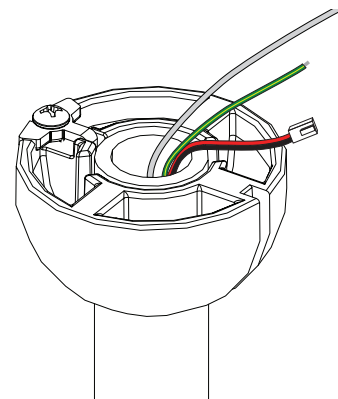
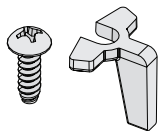

STEPS COMPLETED

Wiring Diagram

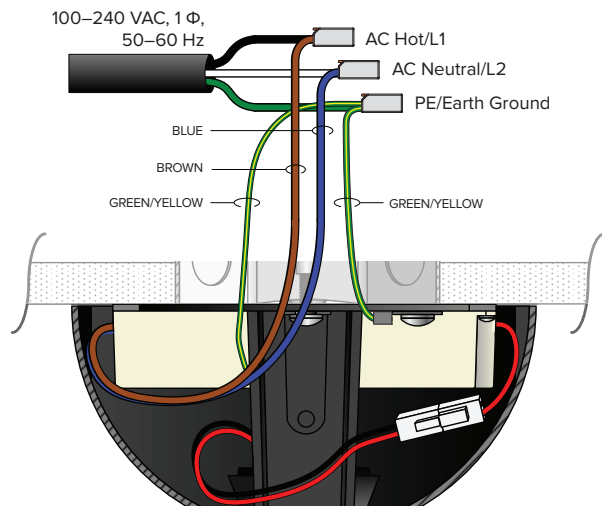
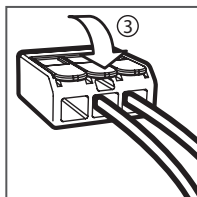
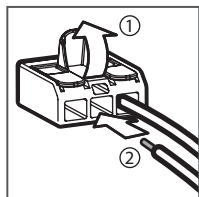
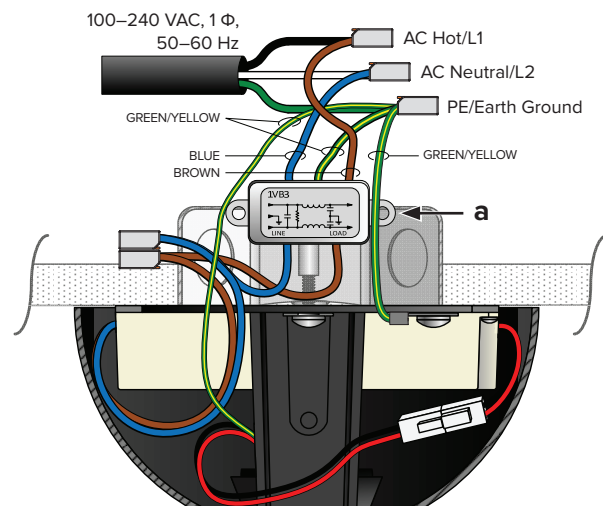
Wiring Diagram
(with EMI Filter)

- ⚠️ Disconnect power to the fan location before wiring the fan!**
 - ⚠️ A licensed electrician must install the fan if required by your local electrical code.**
 - ⚠️ Do not connect the fan to a damaged power source! Do not attempt to resolve electrical failures on your own. Consult a qualified electrician if uncertain of the electrical installation of this fan.**
- 9** Insert the fan wires and ceiling wires into the wire connectors.
- If the EMI filter (α) is included, install it with your fan. Test the connection by lightly tugging on the wires.

	AC Hot/L1 Brown	AC Neutral/L2 Blue	PE/Earth Ground (connected to fan chassis) Green with Yellow Tracer
Australia	Brown or Red	Black or Light Blue	Green with Yellow Tracer
All other regions	Brown	Blue	

HANG FAN

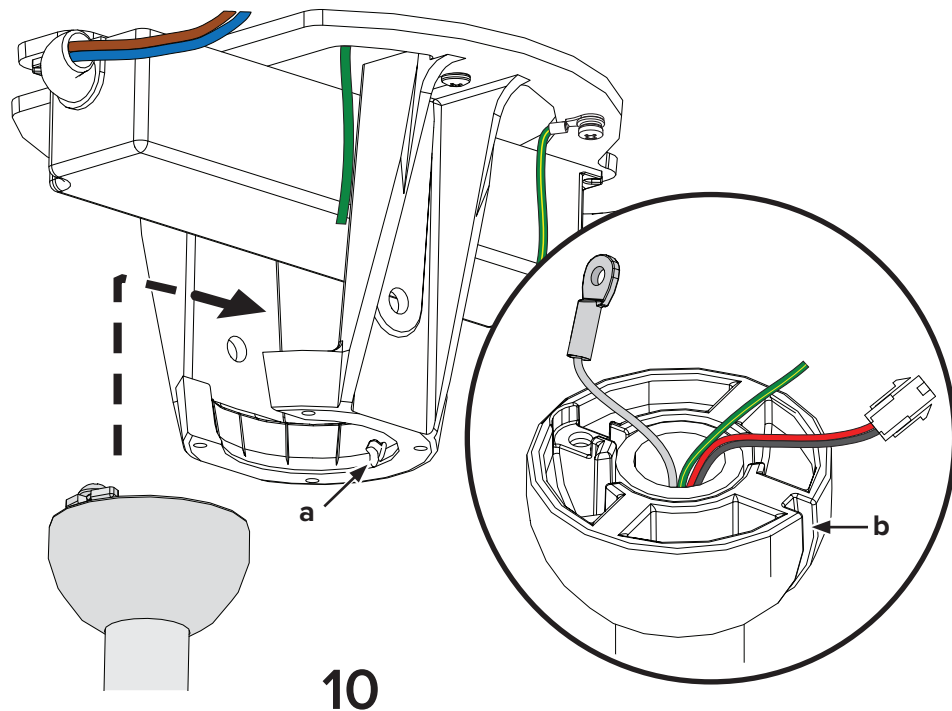

10

CONNECT WIRING HARNESS

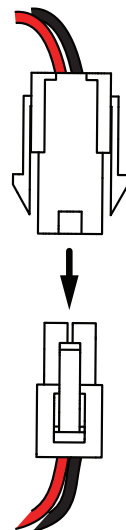

11

- 10** Raise the fan to the mounting bracket. Align the rib in the mounting bracket (a) with the slot in the mounting ball (b), position the mounting ball, and let the fan hang freely. Gently twist the extension tube to ensure it is properly seated and will not move during fan operation.
- 11** Connect the wiring harnesses. Secure the green ground wire from the extension tube to the supply ground wire and the green ground wire on the mounting bracket.

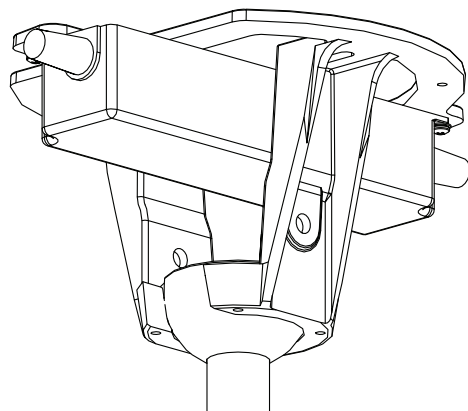

STEPS COMPLETED

SECURE SAFETY CABLE

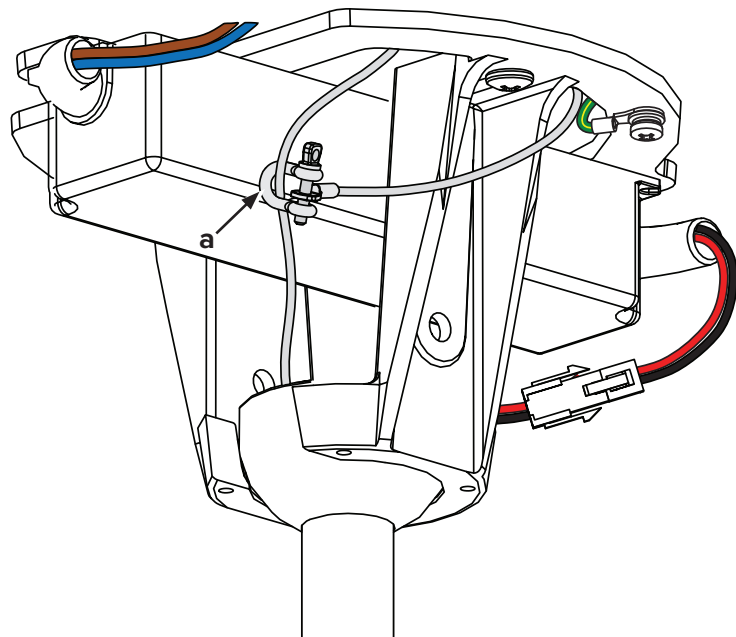

12

INSTALL CANOPY

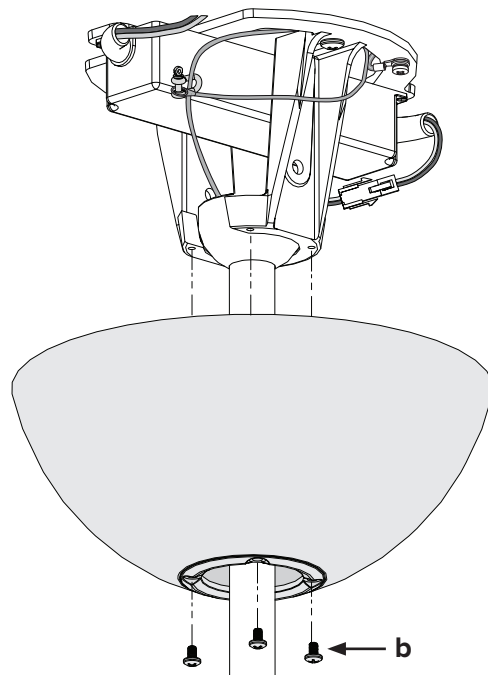

13

- 12** Loop the safety cable around the mounting bracket or building structure, and then secure it with the shackle.

Hardware:

a. Shackle

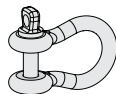

- 13** Raise the canopy to the mounting bracket, lining up the four holes on the canopy with the holes on the bracket. Secure the canopy to the mounting bracket with the painted screws. Make sure no wires or the safety cable are showing.

Hardware:

b. M4 x 6 mm painted screws

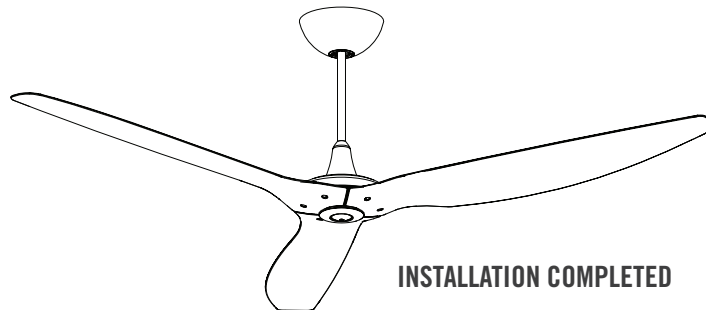

6 TEST YOUR FAN

Do not expose the remote control to rain or water.

Before using the remote control, remove the plastic tab from the battery tray.

Turn on power to the fan location and test functionality using the remote. Turn on the fan and test speed and light brightness.

If you purchased the Haiku Wall Control, follow the instructions packaged with the wall control.

For operation, maintenance, and troubleshooting information, visit haikuhome.com/help

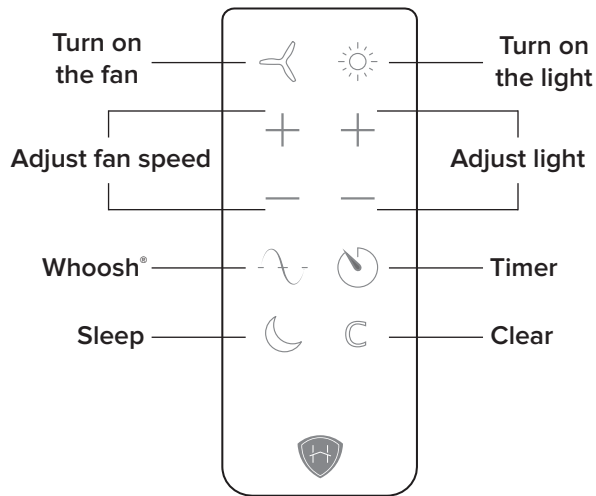

© 2015 Haiku Home

The information contained in this document is subject to change without notice. May be protected by one or more patents listed at www.bigasssolutions.com/patents

Haiku is a trademark of Delta T Corporation, registered in the U.S. and/or other countries.

www.haikuhome.com/warranties

H



HKU-INST-98-ENG-01